

### 1 The Westgate - a landmark for modern Budapest.

One of our basic ideas is that at the end of the building process we will have more green areas than we had at the beginning.  
Another idea is to connect the green heart with the neighborhood green areas.  
This will permit us to create attractive pathways leading from this green heart and the metro station to the neighborhood areas.  
The green terraces are recreational areas and an integral component of the leased object. Use and maintenance are the responsibility of the tenant.

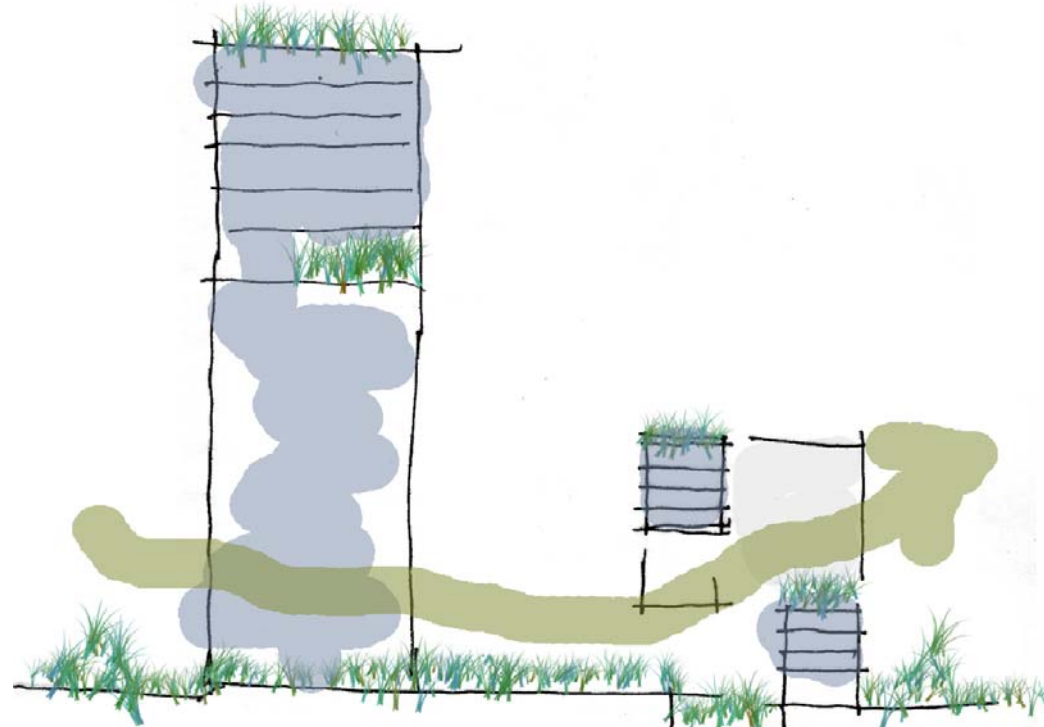

### more green than before ...

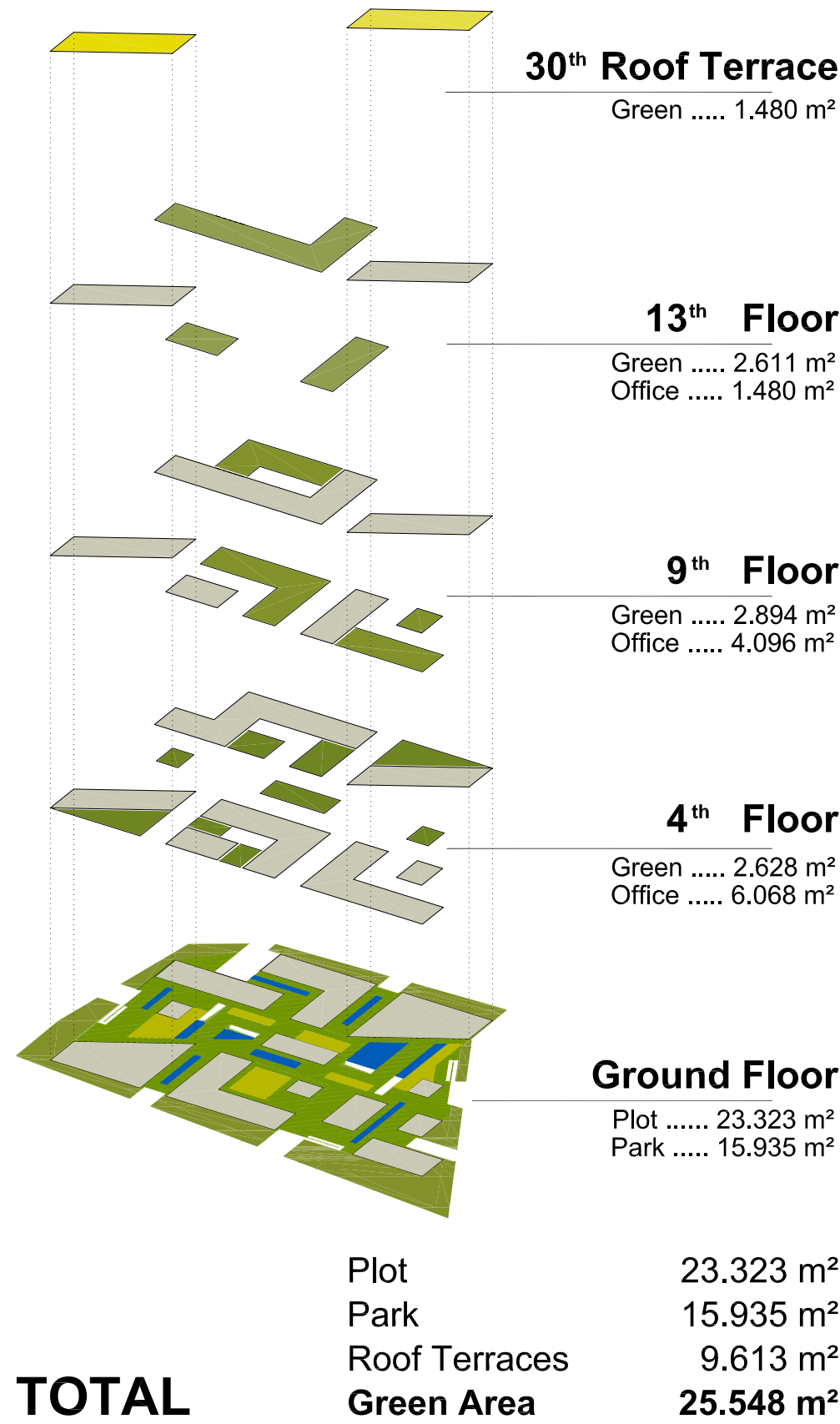

### TOTAL

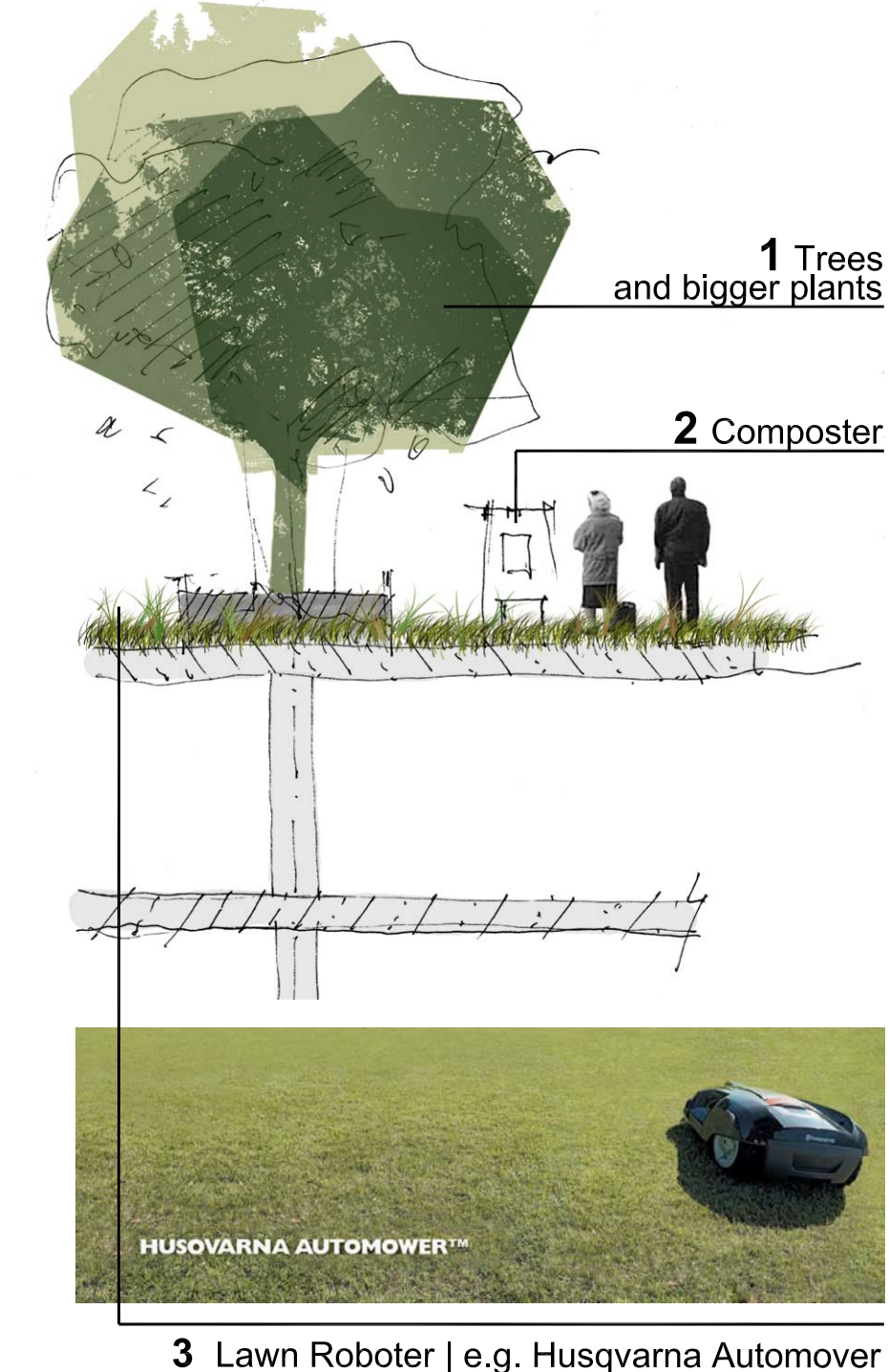

The design and maintenance of green terraces is simple and low priced.

1 Trees and bigger plants are arranged in containers directly above the columns, so there is no need of special constructions.

2 On each terrace there is a composter, the greenery can be recycled and need not be put away (which is especially important for the higher levels).

3 The green areas are maintained by automowers independently and fully automatically.

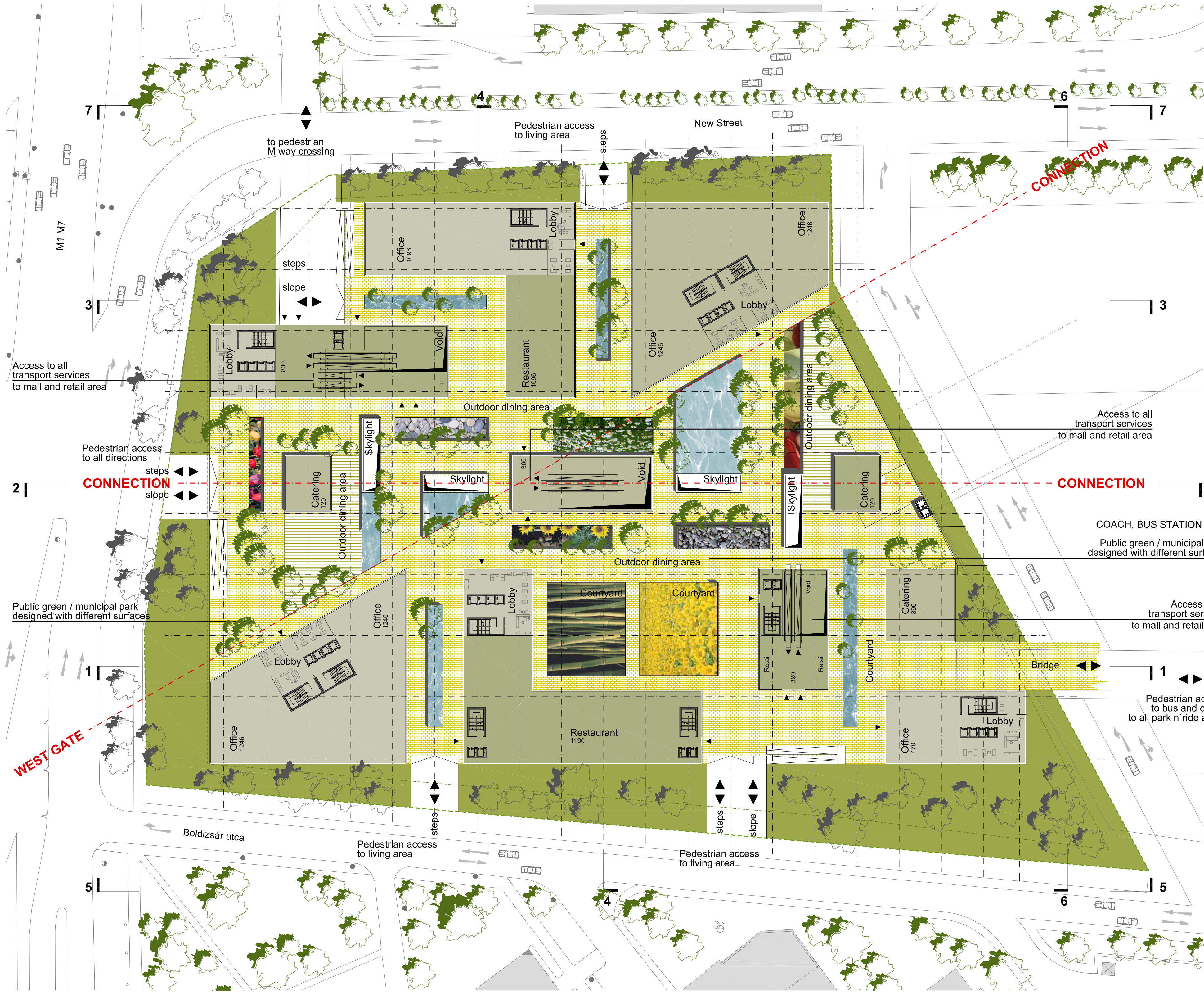

### Ground Floor Plan | 1:500

Ground Floor - 3<sup>rd</sup> Floor  
6,680 m² | 6,834 m² + 600 m²  
28,228 m²