

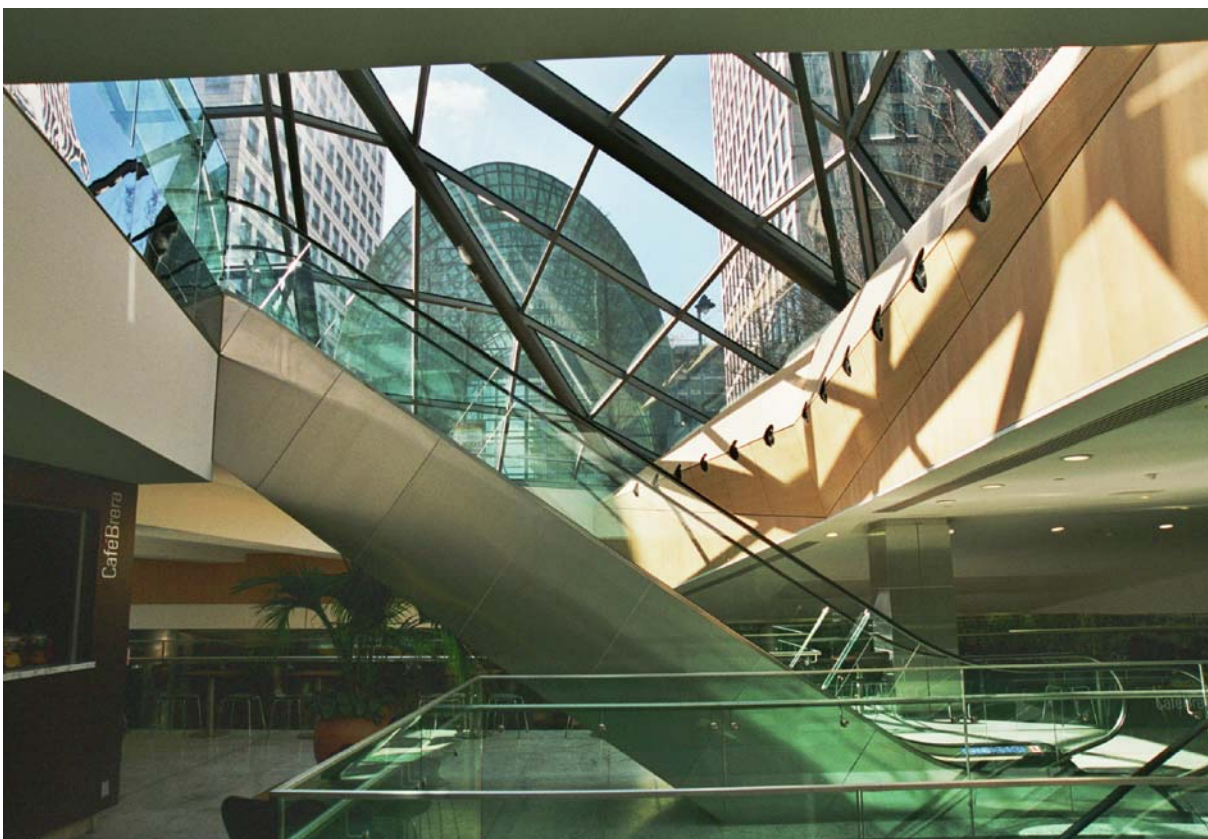

SC Supernova | Ljubljana

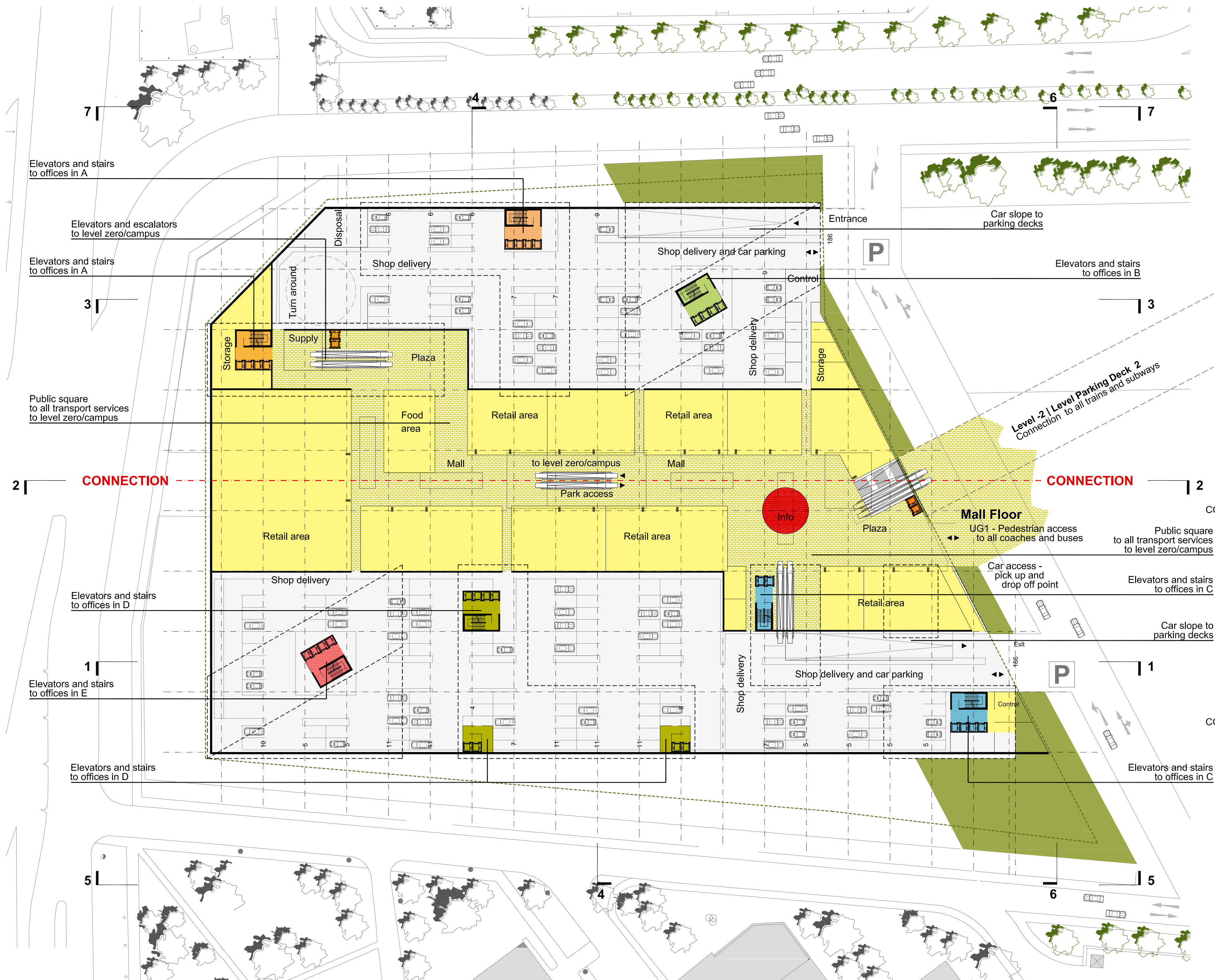

Canary Wharf Mall | London



2

The shopping mall for daily use is located at the same level (UG1) as the bus and the metro station. The shopping mall is open to daylight and naturally ventilated with open squares at both the beginning and the end where the elevators and escalators are located for access to the park areas.

An important project feature is that this shopping mall is situated in UG1 to guarantee uninterrupted business as a local retail supplier throughout the entire construction period (4-6 construction phases) which will have an expected duration of approx. 10 years.

The lobbies are located on the ground floor and can be accessed from the park area. The vertical cores are situated in a way to be connected to the shopping mall. Thus the lobby cannot only be reached via the park but there will be covered paths ways linking the cores via the mall to the metro, bus and railway stations as well as to underground parking.

Mall Floor Plan | 1:500
8.130 m² - retail and mall
17.339 m² - gross area