

The proposed area of intervention is located near Drava River, on the western side of the old city of Maribor. It is framed by two parts, north and south of e street, alongside the river and characterized in its topography by its pendant oriented southwards, and deprived of the surrounding urban character.

The option by the organization in proposing, on one hand, the demolition of the existing buildings in the centre of the northern block and to the south and west of the southern block, and on the other hand, the preservation of the two floor building to the east, establishes the starting point of the intervention, which is intended to be decisive and clear in the planning of the area.

Besides the above guidelines, it is also a requirement of its competition to keep E Street in its current position, and the diminution of traffic in both E Street and Protarska street. Traffic would be converged to RA Bregi Street from Protarska Street to access the market's parking lot.

Located in a key spot of the relationship of the city with its river, the proposed solution consists of the creation of a square and a garden, and the characterization of the existing E Street, this way structuring and ordering the intervention area, which conform the implementation of the building of the complex of the new LGM.

In spite of the diversity and complexity of the programme, it is intended that the building is read as a cohesive and unique piece by the clear treatment given to the volume both in its horizontality and in the way it touches the ground floor.

Square, street and building are thought as one gesture at one tempo.

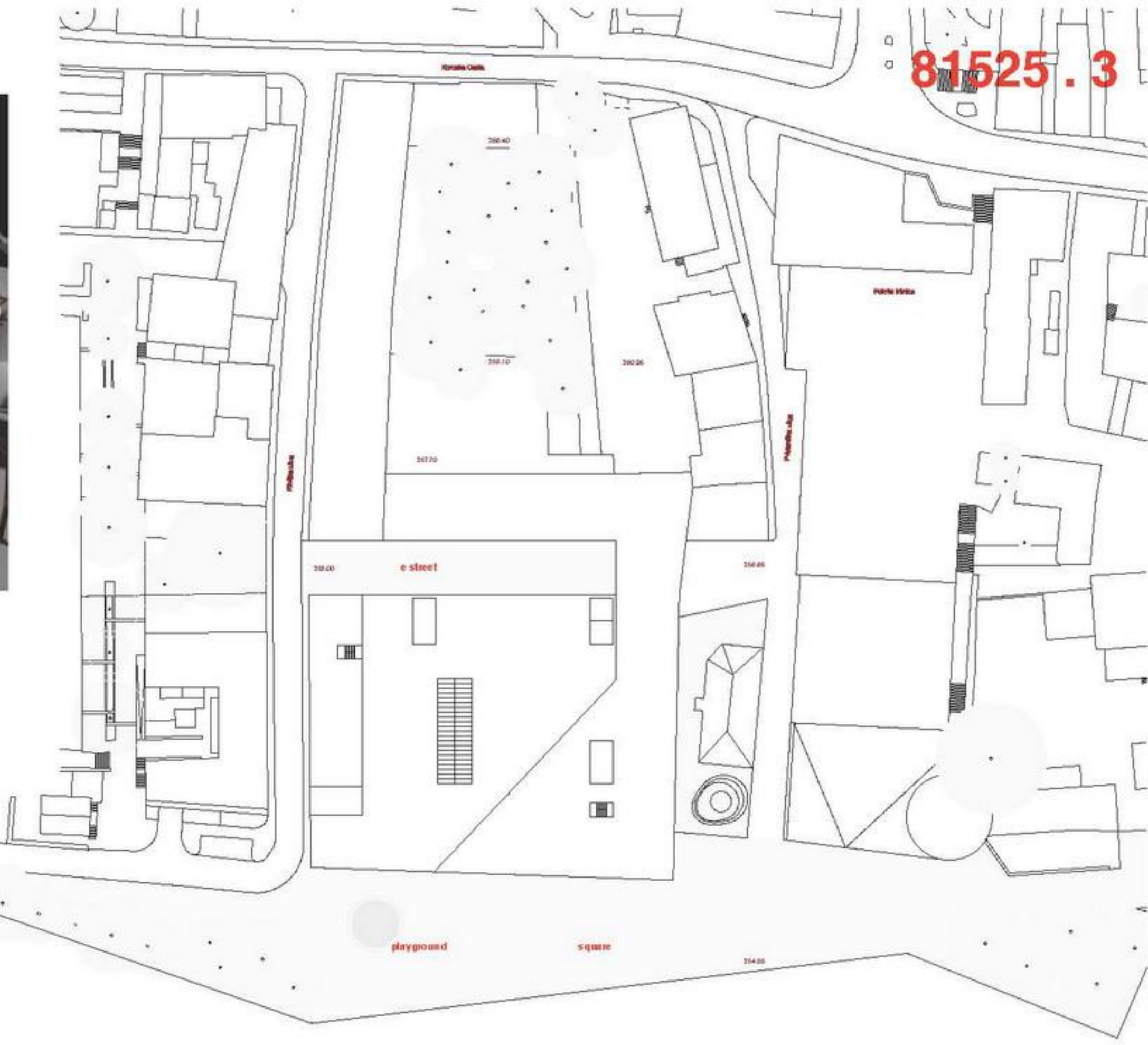
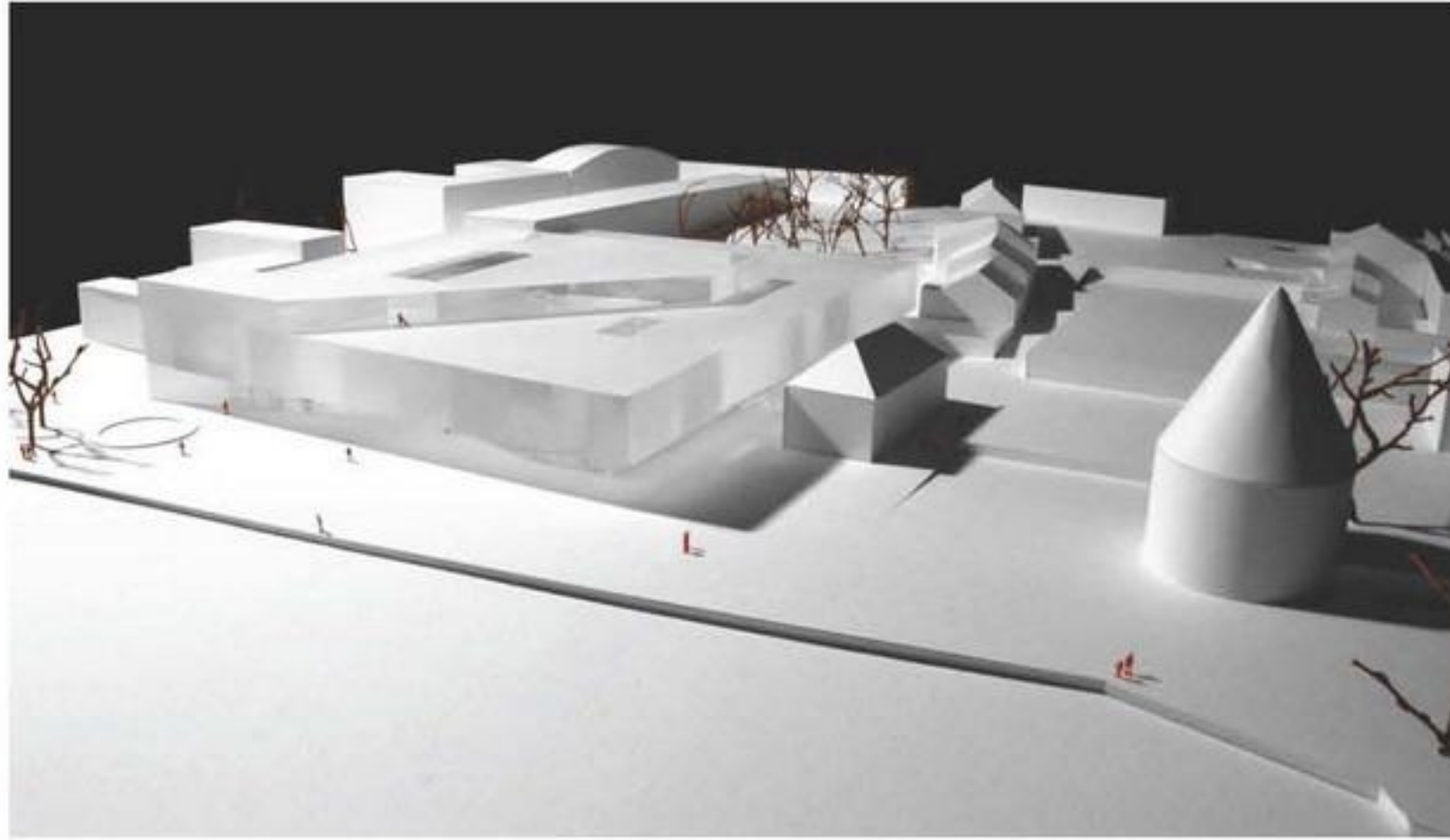

drava river

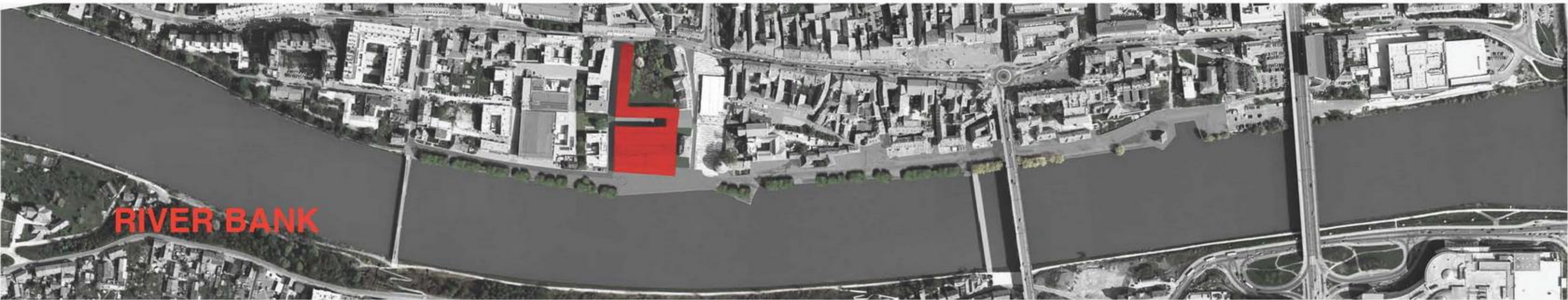

RIVER BANK