

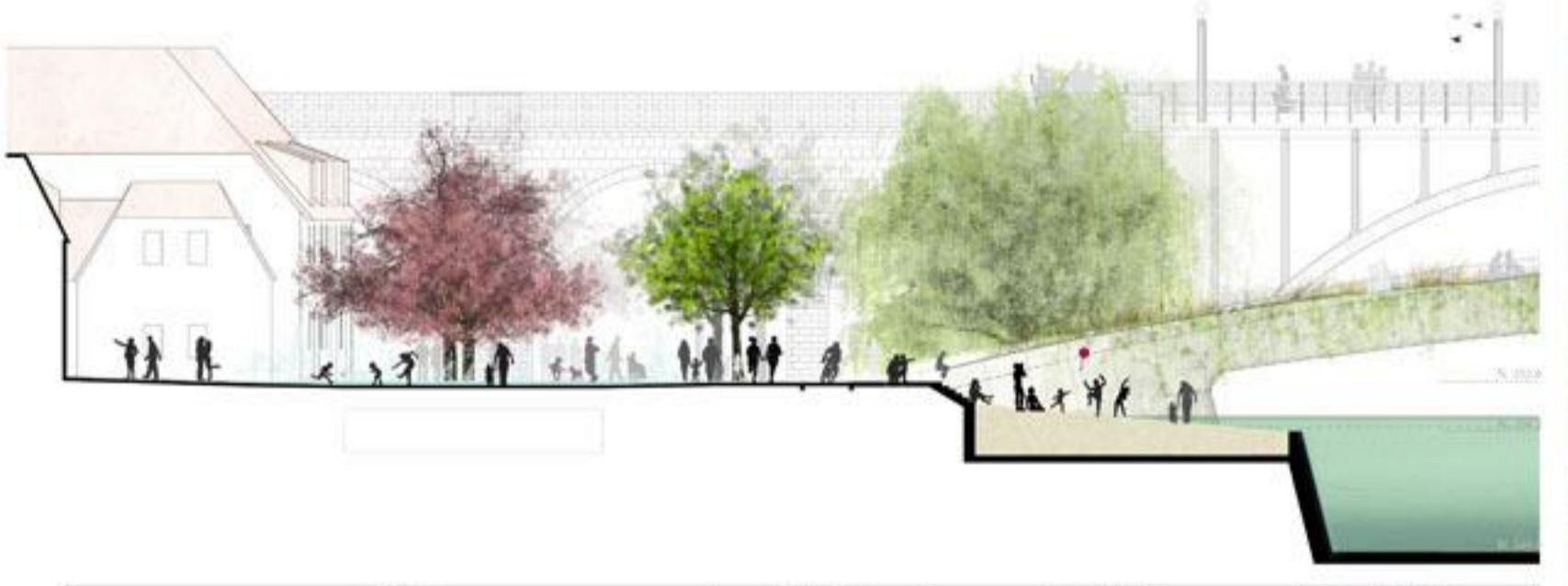

BENETKE ZOOM 1:200



SECTION BENETKE 1:200



SECTION LENT 1:200



SECTION TABOR 1:200

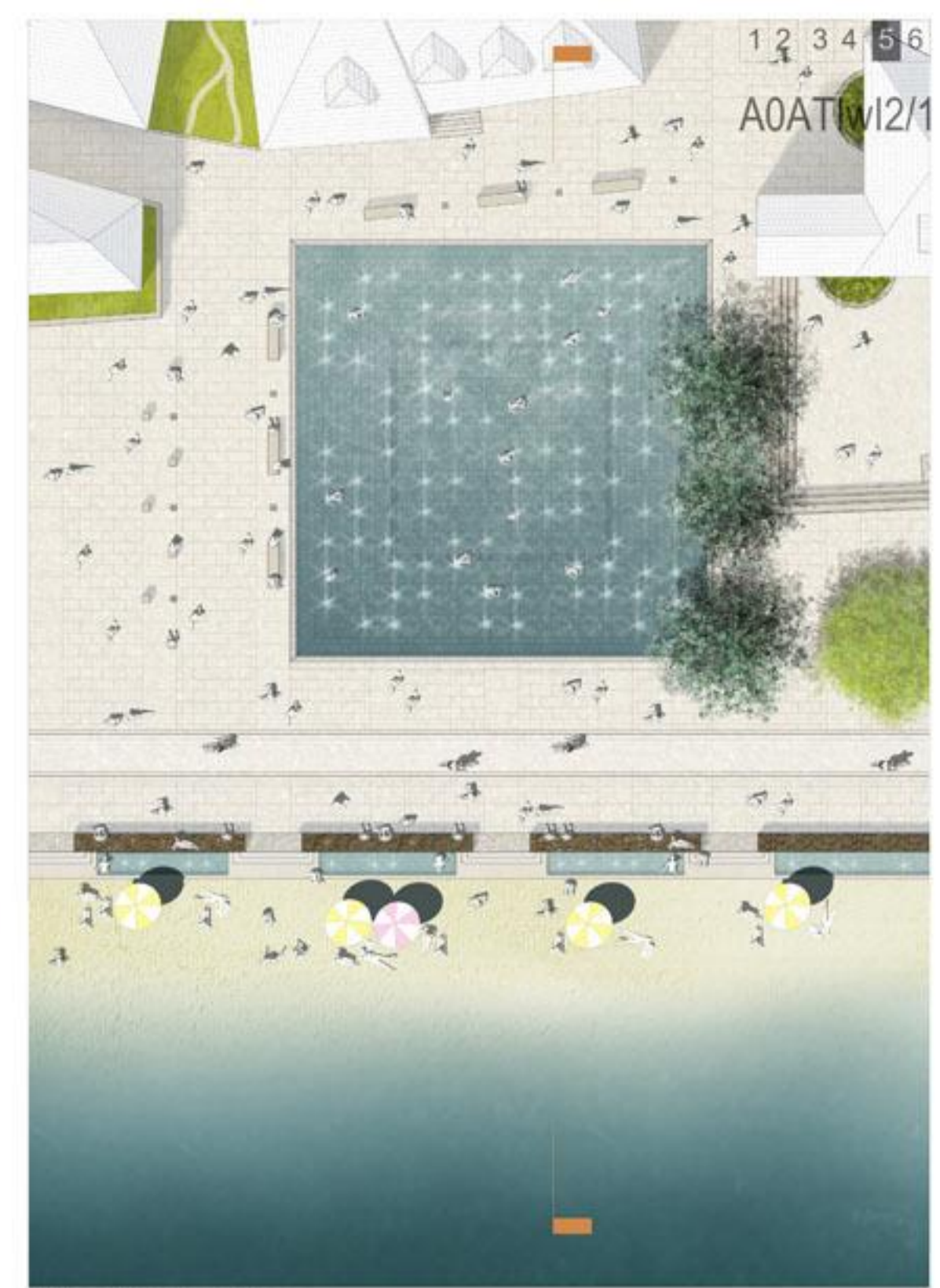

LENT SQUARE ZOOM 1:200

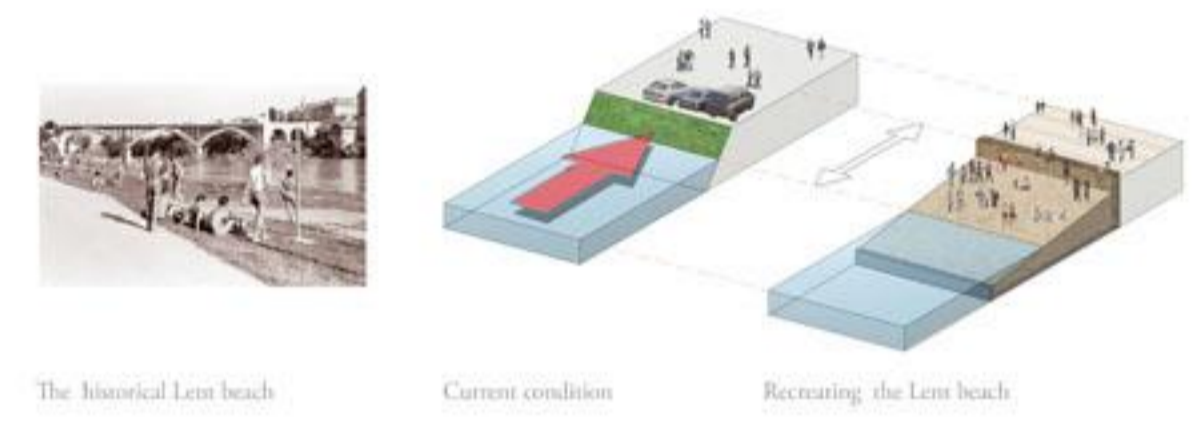

The historical Lent beach  
Current condition  
Recreating the Lent beach



Medieval fortification wall  
Existing (almost invisible) wall  
New urban wall



TABOR ZOOM 1:200



**Lent Square.** The remaining evidence of Lent square's attempts at becoming an attractive and active city ambience have turned out to be insufficient: a small fountain, a typological feature found in historic squares and plazas makes its presence in a very shy manner. In a reinterpretation of this unique water feature present in Lent, we put forward a floodable square (both literally and figuratively) reminiscent of Piazza San Marco in Venice: a contemporary fountain. This square may be easily drained or filled 2cm according to the needs of the city. Several water sprinklers can be activated in a hot summer's day to create a refreshing mist cloud. Water can be drained for the Lent Festival or whenever required. It can even become an ice rink in winter, like Rockefeller Center.

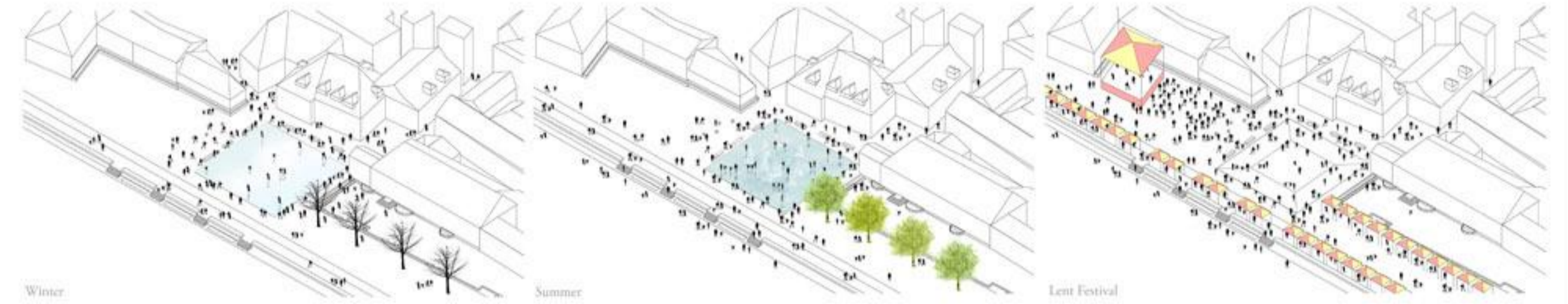

SECTION 1:20



**BENETKE**  
After carefully studying historic documents and photographs we retraced the previous medieval fortification wall. Instead of rebuilding the wall exactly as it was, we reinterpreted the wall and its form. The benetke pier would become a large walled garden with abundant trees and vegetation species. Like the fortification wall in Lucca (Italy) the defensive structure invaded by green will become a paradoxical image that no longer speaks of a defensive fort, but of a magical enclosed urban garden open to the public.

