

between SKY and GROUND

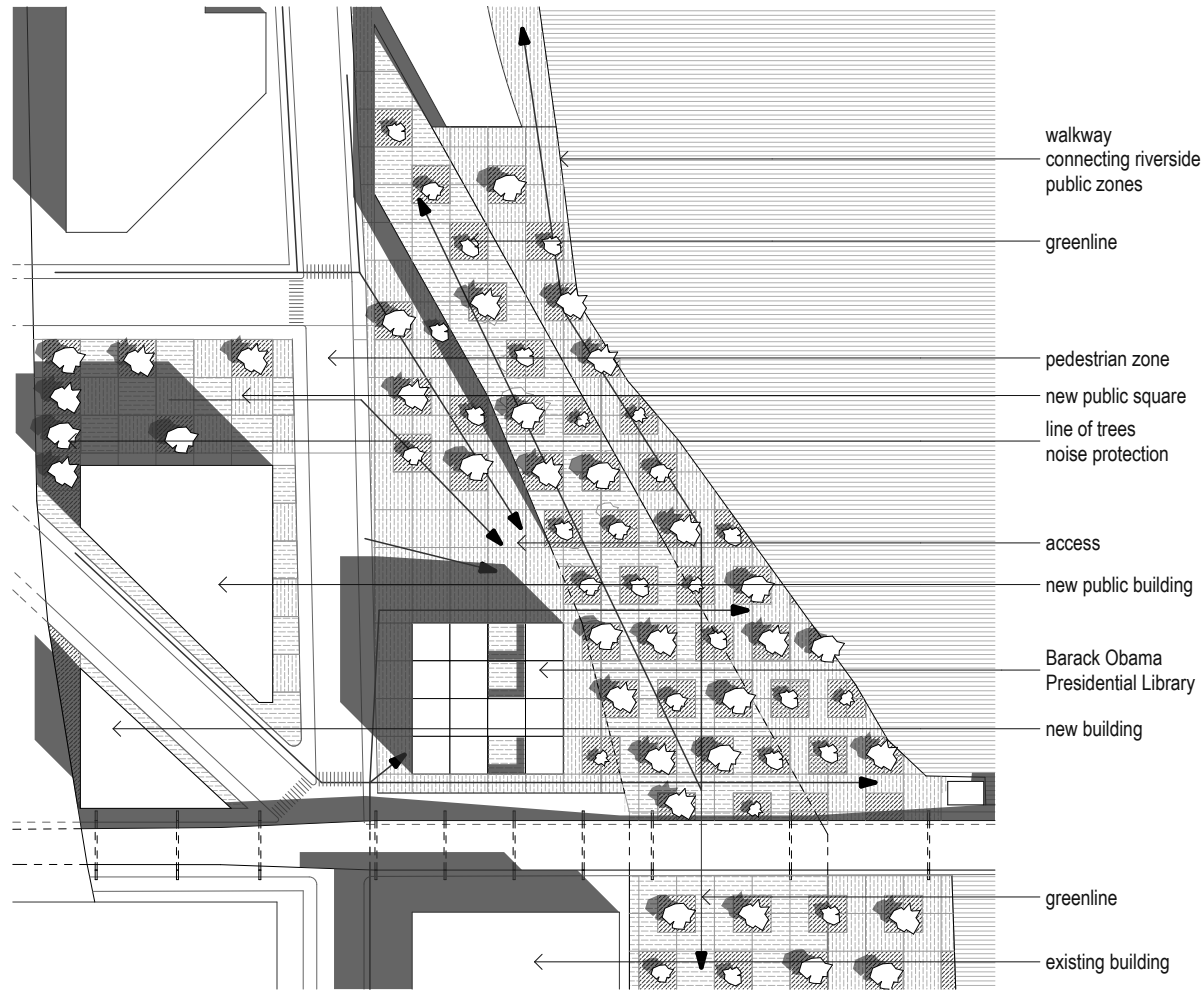

Masterplan

Statement

Libraries and museums in our time are not only reserve artifacts and books but offer different events to visitors, host educational and civic programs, ensure **flexible** spaces for exhibitions, vitalize social life of their community. The Presidential Library also has to represent the legacy, to be an emphasized spot which **involves** people and links them together.

A wide and open public square **combines** the elements of the city context, **connecting** the river, the platform of the tracks and street level, situates new and existing buildings an exciting interaction. The gently rising terraced slope is a mixed combination of small intimate platforms, open air exhibition spaces, green surfaces, ramps and stairs, accessible from every direction. These set of various and well-defined levels **embrace** and include the ground floor of the library, and lead to the main and most exciting series of covered and open spaces on the first floor. Various ceiling height enhance the experience of the voids, ensuring **intimacy** and **openness** at the same time. Indoor exhibition and library rooms are situated on upper stories organized by the similar space typology.

The **contrast** between the rough and weighty concrete slabs on the ground floor and the lightsome white box hovering above them reflect to the duality of the building typology. The teeming and **pulsing** urban forum and the calm, dignified exhibitions rooms are connected by empty voids waiting to be filled with thoughts.

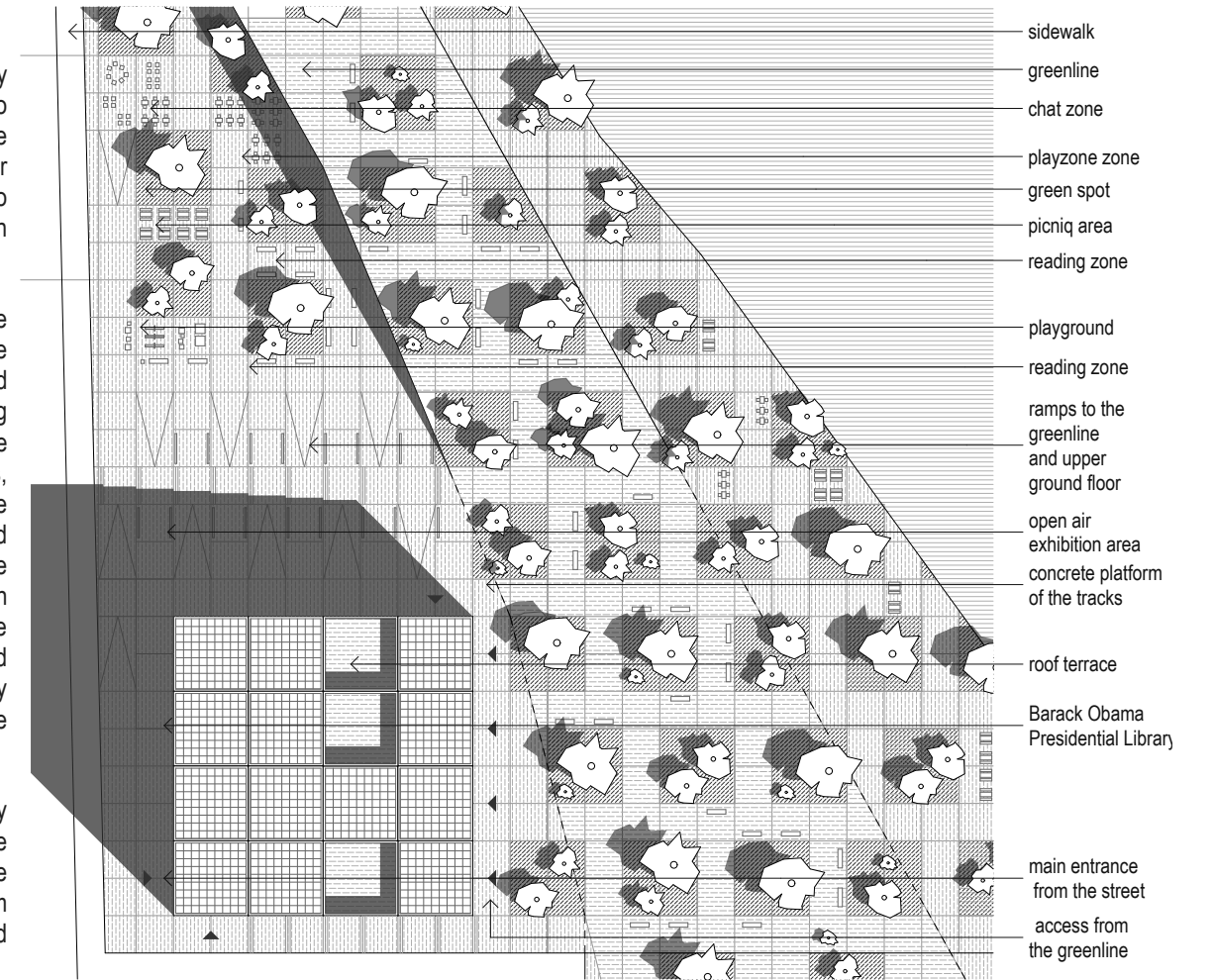

Masterplan

